

MOPAR / HEMI



Performance specific and durability enhanced, Callies crankshafts for the Big Block Mopar and Gen III Hemi are ready for anything your racing program can throw at them. With years of Mopar experience Callies has created an unsurpassed crankshaft for your Wedge or Hemi type engine.

Ultra Series for Big Block Mopar Top Fuel, Top Alcohol, Blower Drive

Standard Features

- Machined from EN30B alloy steel
- Rod journal diameters: 2.375" with large .180" fillet radii
- Main journal diameters: 2.750" or 3.000" with large .150" fillet radii
- RCD Splined post: long 2.340" or short 1.420" spline engagement available
- Sold complete with no drill balance included
- Aeroshed super finishing is standard
- Fully counterweighted with large, bearing saver counterweights
- All rod and main journals drilled for lightening
- PSI / RCD Spline Post Hemi Forged Billet also available

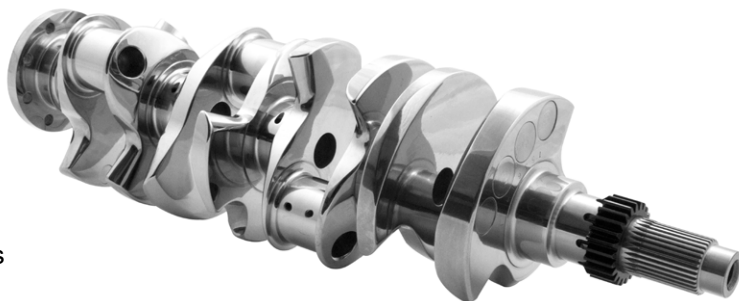

Mopar Magnum Billet

Average weight for a 4.500" stroke balanced to 2350g Bob. = 69 lbs.

Available Options & Standard Features

- Center counterweights
- 4330 Steel
- Gun drilled mains
- All Rod Journals Lightened
- Dual Post Keyways
- Stroke availability 4.125" to 5.000"
- 2.200 BB Chevy rod journal dia. & width



Mopar Magnum Billet

Stroke:	Main:	Pin:	Cammed for Rod Length	Part #
4.150	2.750	2.200	6.700	GE262@-MB
4.250	2.750	2.200	6.700	GEP62@-MB
4.500	2.750	2.200	7.100	GEQ62@-MB

Stroke:	Main:	Pin:	Cammed for Rod Length	Part #
4.625	2.750	2.200	7.100	GER62@-MB
4.750	2.750	2.200	7.100	GES62@-MB
5.000	2.750	2.200	7.100	GEV62@-MB

Mopar Magnum

Average weight for a 4.500" stroke balanced to 2350g Bob. = 64 lbs.

Available Options & Standard Features

- Gun drilled mains
- All Rod Journals Lightened
- Dual Post Keyways
- Stroke availability 3.750" to 5.000"
- Heat Treatment = Ultra Case Deep Nitride
- Custom Flange Bolt & Dowel Drilling
- 2.200 BB Chevy dia. & width, 2.375 Mopar rod journal dia. & width



Mopar Magnum

Stroke:	Main:	Pin:	Cammed for Rod Length	Part #
4.150	2.750	2.200	6.700	GE262J-MP
4.250	2.750	2.200	6.700	GEP62J-MP
4.500	2.750	2.200	7.100	GEQ62J-MP

Stroke:	Main:	Pin:	Cammed for Rod Length	Part #
4.625	2.750	2.200	7.100	GER62J-MP
4.750	2.750	2.200	7.100	GES62J-MP
5.000	2.750	2.200	7.100	GEV62J-MP



Gen III Ultra UB Hemi

Average weight = 60 lbs.

Standard Features

- Fully (8) Counterweighted design
- Machined from 4330 TimkenSteel
- Uniquely machined counterweight profile for reduced weight and windage
- Gun drilled mains
- All rod journals lightened
- Heat Treatment = Ultra Case Deep Nitride
- Full support pin top for added strength
- Available Upon Request: Full internal balance to your specific assembly weight - No Drilling



Gen III Hemi - 8 Counterweight Magnum

Stroke:	Main:	Pin:	Cammed for Rod Length	Part #
3.720	2.559	2.100	6.125	YY89E1V-MG
3.800	2.559	2.100	6.125	YYK-E1V-MG

Gen III Hemi - 8 Counterweight Magnum

Average weight = 52 lbs.

Standard Features

- Stroke range of 2.800" to 4.600"
- Fully counterweight prepped for a minimum 1850g. bob weight
- Dual linear post keyways
- Average weight 47-55 lbs
- Gun drilled mains & lightened rods
- 2.100", 2.000", 1.888", 1.850" rod journal diameters

Gen III Hemi - 8 Counterweight Magnum

Stroke:	Main:	Pin:	Cammed for Rod Length	Part #
4.000	2.559	2.100	6.125	YYO-E1V-MG
4.050	2.559	2.100	6.125	YY*-E1V-MG



Compstar Gen III Modern Hemi

Stroke:	Main:	Pin:	Cammed for Rod Length	Part #
3.800	2.559	2.100	6.125	YYKE18-CS
4.200	2.559	2.100	6.125	YY12E48-CS

Compstar Gen III Modern Hemi

Average weight for 4.050" stroke balanced to 1785g

Bob. = 57 lbs.

Standard Features

- Sold prepped for a 1785g. Bob weight
- Gun drilled mains
- All rod journals lightened
- Dual linear post keyways

Compstar 8 Counterweight Hemi

Stroke:	Main:	Pin:	Cammed for Rod Length	Part #
3.800	2.559	2.100	6.125	YYK-E1Q-CS
4.000	2.559	2.100	6.125	YYO-E1Q-CS
4.050	2.559	2.100	6.125	YY*-E1Q-CS
4.080	2.559	2.100	6.125	YYA-E1Q-CS

Compstar Big Block Mopar

Standard Features

- 6 Counterweight design
- Manufactured from 4340 steel

Compstar Big Block Mopar

Stroke:	Main:	Pin:	Cammed for Rod Length	Part #
3.760	2.750	2.200	6.535	GE3-65L-CS
4.150	2.750	2.200	6.535	GE2-62L-CS
4.250	2.750	2.200	6.535	GEP-62L-CS
4.500	2.750	2.200	6.700	GEQ-62L-CS
4.625	2.750	2.200	6.700	GER-62L-CS

- All rod journals lightened
- Heat Treatment = Nitride Case
- Counterweight prepped to a 2400 Bob Weight





Compstar Jeep 4.2 Liter Inline 6 Cast Iron

Stroke:	Main:	Pin:	Part #
3.895	2.500	2.096	S28000

Connecting Rods

Mopar Ultra Enforcer I-Beam - Rated for 2,000 HP

Length	Journal	Typ. Wt.	Part #
6.125	2.100		U14240
6.200	2.123	764g.	U14345
6.200	2.100		U14245

Mopar Gen III Hemi Drag Pak Ultra H-Beam

Length	Journal	Typ. Wt.	Part #
6.300	2.100	658g.	U16130

Compstar Xtreme - SBC Style : Use with Gen III Hemi Rated for 1,800 HP

Length	Journal	Typ. Wt.	Part #
6.000	2.100	645g.	CSA6000DS2A2AX
6.125	2.100	653g.	CSA6125DS2A2AX

Gen III Hemi Compstar H-Beam - Rated for 1,000 HP

Length	Journal	Typ. Wt.	Part #
6.125	2.100	617g.	CSA6125DS2A2AH
6.150	2.125		CSD6150GS2E1AH
6.250	2.125		CSD6250GS2E1AH

Big Block Mopar Ultra H-Beam

Length	Journal	Typ. Wt.	Part #
7.100	2.200	864g.	U16250
7.200	2.200	868g.	U16255

Compstar Xtreme - BBC Style : Use with Big Block Mopar Rated for 1,800 HP

Length	Journal	Typ. Wt.	Part #
6.700	2.200		CSB6700ES3BDAX

Big Block Mopar Compstar H-Beam - Rated for 1,000 HP

Length	Journal	Typ. Wt.	Part #
6.760	2.375		CSE6760FS3D5AH
6.700	2.200	825g.	CSB6700ES3B9AH
6.800	2.200	842g.	CSB6800ES3B9AH
7.100	2.200		CSB7100ES3B9AH

* All Ultra connecting rods can be upgraded to Custom Age Bolts. (-CA)



Head Studs for Gen III Hemi - Cast Iron Block

Part #:	Material:	
CPP10625	Patriot Grade	20 M12 & 10 M8
CPP10626	TorqueMaster	20 M12 & 10 M8

Main Studs for Gen III Hemi - Cast Iron Block

Part #:	Material:
10414	Patriot Grade
10414-TM	TorqueMaster



OptiTorque	Material Grade	OptiTorque Tensile Strength
Patriot	8740 Chrome Moly	180-220 ksi
TorqueMaster	HSLA 6304	190-240 ksi



Gen III Main Caps

- Billet 4140 Material
- Fits OEM Cast Iron Blocks
- ID sized for proper boring and honing

Gen III Main Caps

- Part #:
- 000-G3HKIT Main Caps
 - 000-G3HMSTK Main Caps / Main Stud Combo
 - 000-G3HMHSTK Main Caps / Main & Head Stud Combo



M16 Damper Bolt

- Part #:
- 06512335AA



Gen III Hemi VVT Post Spacer

- Part #:
- CPP-0550

Used in all VVT applications

Gen II Hemi / Wedge Cast Iron Block Components

- Part #:
- 832486-5-A-M Main Bearing Cap #1,2,4
 - 832486-5-B-M Main Bearing Cap # 3
 - 832486-5-C-M Main Bearing Cap #5
 - 000-1256 Rear Oil Seal Retainer
 - HAR3.500-5 Hex Bolt, 1/2-13 x 3.500
 - HAR4.000-5 Hex Bolt, 1/2-13 x 4.000
 - H3AJ2.750-5CL Hex Bolt, 3/8-16 x 2.750
 - ARW78 Chamfered Washer 1/2 ID x 7/8
 - RJW750 Chamfered Washer 3/8 ID x 3/4
 - P5007167-7 Hollow Dowel 0.700x0.625
 - 000-1257 Hollow Dowel Rev. IR 4340 CFA
 - 91271A638 3/18" - 16 Thread Size, 3 1/2" Long Bolt

- Part #:
- 91375A617
 - P1737725
 - 555-030-B
 - 22S-S12
 - 555-065-B
 - 44605K232
 - 44605K233
 - 27931
 - 91251A539
 - PD-17
 - 1122532

- Oil Gallery 3/8"-16 Plug 0.040"
- Distributor Bushing - Bronze
- Press in Freeze Plugs 1.625"
- 12 AN Plug - Aux Pick Up
- Press In Rear Cam Plug 2.1406
- 1/4"-18 NPTF Pipe Plug
- 3/8"-18 NPTF Pipe Plug
- 1/2" Oil Pick Up Tube Adapter
- 1/4"-20x5/8" A574 Socket Head
- Durabond Camshaft Bearing Kit
- Dowel - Bell Housing 1/2"x3/4"



Reluctors

<u>Part #:</u>	
05037457A	32 Tooth Chrysler 6.4 OEM Reluctor
05037457AA	32 Tooth Chrysler 6.4 Billet Reluctor
04893290AA	58 Tooth Chrysler 6.4 OEM Reluctor
04893290AAB	58 Tooth Chrysler 6.4 Billet Reluctor



32 Tooth 6.4 OEM Reluctor



58 Tooth 6.4 Billet Reluctor

Reluctor Bolts

<u>Part #:</u>	
0658103AA	Hemi reluctor bolts

Callies Finish Ground Cams

Callies fully finished camshafts are machined and heat treated entirely in house. This continuity of manufacturing allows Callies to deliver high quality camshafts on schedule. Our finished cams are ground with the latest Landis CNC technology. They are ADCOLE and Jenoptik inspected for accuracy, making them the most consistent cams on the market today. If required, your cams can be finished with inverted flank lobe profiles and complex VVT oil channels and drillings.



Callies offers cams to serve a wide variety of applications for many popular engine platforms.

Callies cams are available in multiple types of aircraft quality materials. Less aggressive profiles fit nicely within our induction hardened 1050 or 4150 materials. 8620 carburized material works well for many racing applications. Tool steel is available for the most extreme applications.

Callies Finish Ground Cam List - VVT Gen 3 Hemi

Callies Part #	Solid or Hyd	Duration @ .050		Advertised Duration (@ .006)		Cam Lift		Valve Lift w/1.6 Rocker		LSA + Advance	Lobe Ctr.		Lift @ TDC		Application
		Intake	Exhaust	Intake	Exhaust	Intake	Exhaust	Intake	Exhaust		Intake	Exhaust	Intake	Exhaust	
141 - VVT Hemi															VVT Gen 3 Hemi
141-001	HR	232	242	282	292	0.385	0.385	0.616	0.616	116 + 10	106	126	0.084	0.037	Low speed grunt
141-002	HR	236	246	286	296	0.385	0.385	0.616	0.616	118 + 10	108	128	0.084	0.037	Great balance of performance
141-003	HR	240	250	290	300	0.385	0.385	0.616	0.616	120 + 10	110	130	0.084	0.037	More high speed street power
141-004	HR	242	252	292	302	0.390	0.390	0.624	0.624	119 + 10	109	129	0.091	0.042	Street / strip performance
141-005	HR	246	256	296	306	0.390	0.390	0.624	0.624	121 + 10	111	131	0.091	0.042	Big street / strip w/ big displacement engine
141-006	HR	256	260	300	310	0.390	0.390	0.624	0.624	123 + 10	113	133	0.091	0.042	Geared towards racing

MOPAR / HEMI



Without steady and reliable access to a **Gen II Cast Iron Hemi** in over a decade car enthusiasts and sportsman racer's have been left to scour scrapyards, market places, and garages to create a workable and affordable solution. Our new licensing deal with FCA group will allow you to tap into this legendary platform on demand at an affordable price.



**OFFICIAL
LICENSED
PRODUCT**

HEMI[®]

Gen II Cast Iron Hemi / Wedge

Standard Features

- Configurations Available for Order:

<u>Description</u>	<u>Part #</u>
Hemi with 4.495" Semi Finish Bore	P5160208AA
Hemi with 4.245" Semi Finish Bore	P5160210AA
Hemi with 4.245" Semi Finish Bore - No lifter bores or pushrod clearance	P5160211AA
Wedge with 4.495" Semi Finish Bore	P5160213AA
Wedge with 4.313" Semi Finish Bore	P5160212AA

ENERGY
MANUFACTURING

- Deck Height(s): Standard Deck: 10.725", Deck Thickness: .600"
- Camshaft: Cam Height: Standard 5.150"
- Camshaft: Housing Bore: Delivered with Standard Stepped Cam Tunnel at finish size. Max Cam Housing Bore Size: 60mm Roller Bearing.
- Cylinder Bore: Max Cylinder Bore Diameter: 4.600"
- Lifter: Lifter Diameter: .905", Lifter Angle: 45 degrees
- Main Cap Fastening: #1-4 Main Cap: (2) 1/2" Vertical Bolts, (2) 3/8" Side Bolts, #5 Main Cap: (2) 1/2" Vertical Bolts
- Delivered with Finish Honed Crankshaft Housing Bore

Included with Block: Block Plug Kit, Camshaft Bearings (Loose), 0.040" Oil Gallery Restrictors (Installed), Rear Oil Seal with Fasteners.

All block part numbers can have cylinder bores finish honed upon request for an additional charge.

Orders for the Gen II Cast Iron Hemi / Wedge Block can be placed by calling Callies Performance Products

MOPAR and related logos, vehicle model names and trade dress are trademarks of FCA US LLC and used under license. ©2024 FCA US LLC

Callies Performance Products www.callies.com 419-435-2711



**OFFICIAL
LICENSED
PRODUCT**

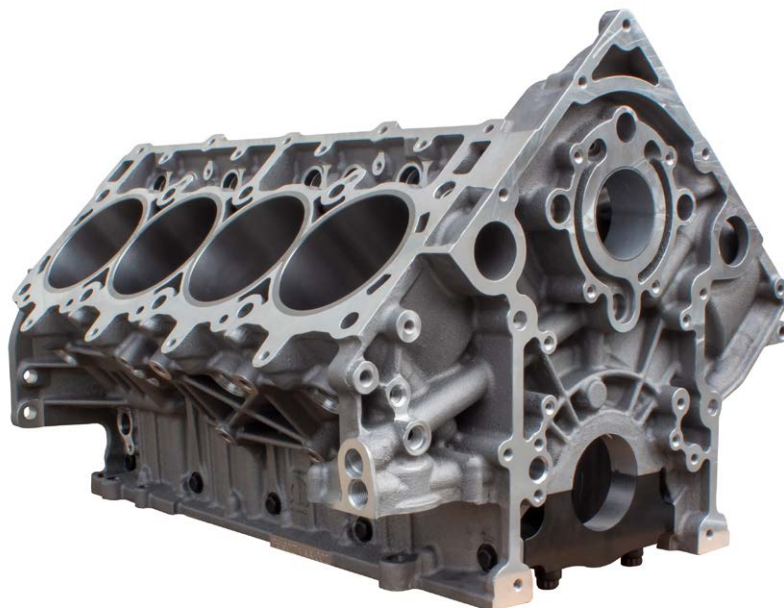
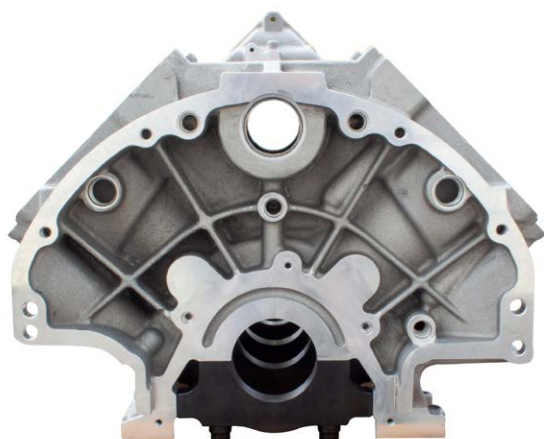

Gen III Cast Aluminum Engine Block

Standard Features

Hellephant Block: P5160271AA

- 9.25" Deck Height
- 6.2/6.4 Timing Drive, VCT Solenoid
- Standard Lifter Pattern, .842 lifter bores
- Standard cam bore, bearings installed
- Delivered w/ 4.120" bores, require finish honing to 4.125"
- 4140 q/t billet main caps
- 4 bolt M1 & M5, 6 bolt M2-M4
- M12 Head Studs Available

ENERGY
MANUFACTURING

Drag Pak Block: P5160272AA

- 9.25" Deck Height(stock is 9.284")
- 6.1 Timing Drive, No VCT Solenoid
- .937 Keyway lifter bushings, require finish hone
- 60mmRB cam bore, bearings not included
- Delivered w/ 4.120" bores, require finish honing to 4.125"
- 4140 q/t billet main caps
- 4 bolt M1 & M5, 6 bolt M2-M4
- ½" Head Studs Available
- *Requires Unique Head Gasket - Cometic Part # H4121SP6058S and H4122SP6058S*

Orders for MOPAR Blocks can be placed by calling Callies Performance Products at 419-435-2711

MOPAR and related logos, vehicle model names and trade dress are trademarks of FCA US LLC and used under license. ©2024 FCA US LLC

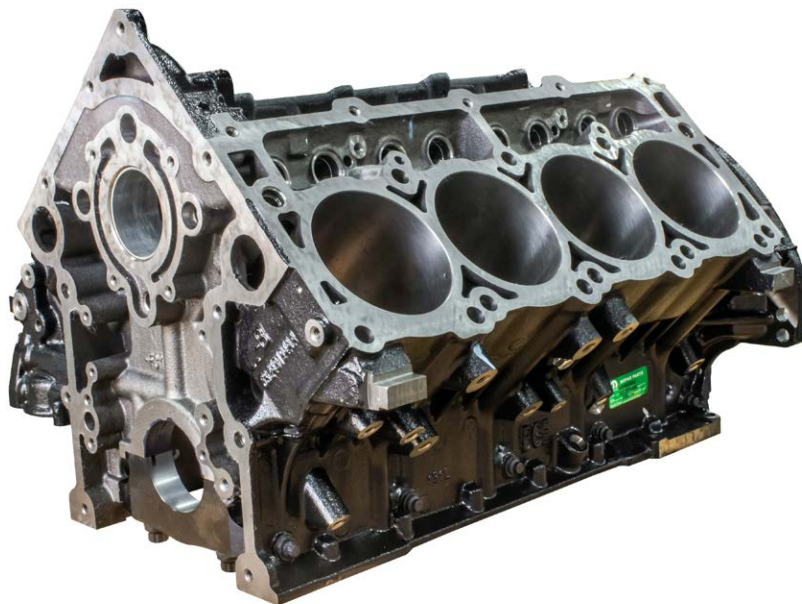
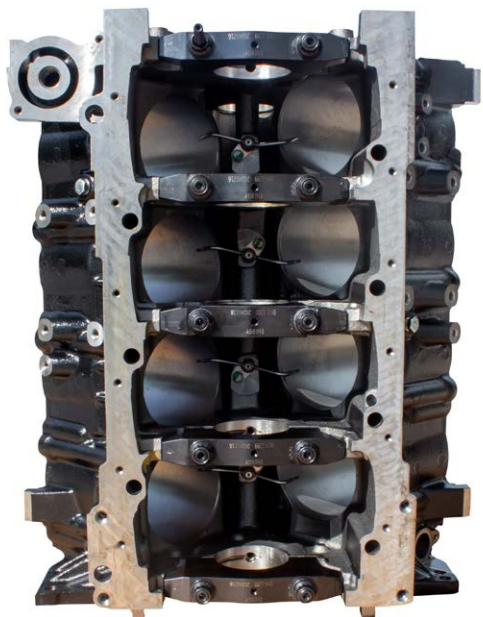

Gen III Hemi 6.4L Cast Iron "BGE" Bare Block

Description

6.4L Block only

- With OptiTorque main stud kit
- With main studs and Energy main billet caps
- With studs, caps, and line honing installed

Part

05045475AG

600-901-20

600-902-20

600-903-20

 **6264**

Hellcat 6.2L Bare Engine Block

Description

6.2L Block only

- With OptiTorque main stud kit
- With main studs and Energy main billet caps
- With studs, caps, and line honing installed

Part

68166434AD

700-901-20

700-902-20

700-903-20

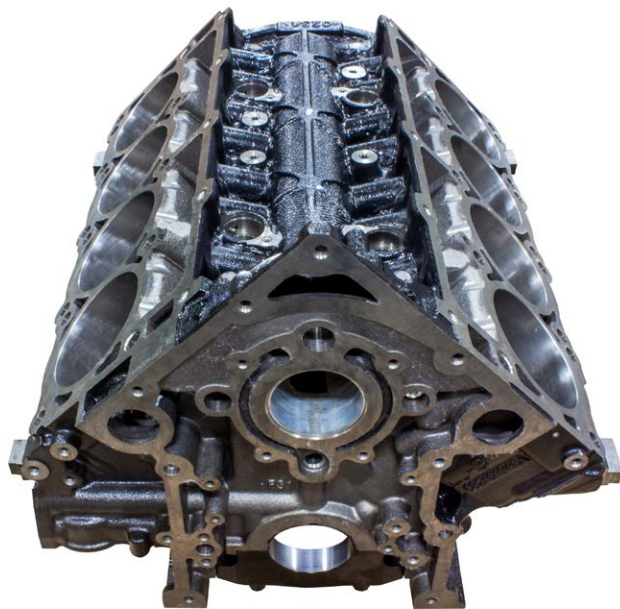

**OFFICIAL
LICENSED
PRODUCT**

Orders for MOPAR Blocks can be placed by calling Callies Performance Products at 419-435-2711

MOPAR and related logos, vehicle model names and trade dress are trademarks of FCA US LLC and used under license. ©2024 FCA US LLC