

MOPAR / HEMI



Performance specific and durability enhanced, Callies crankshafts for the Big Block Mopar and Gen III Hemi are ready for anything your racing program can throw at them. With years of Mopar experience Callies has created an unsurpassed crankshaft for your Wedge or Hemi type engine.

Ultra Series for Big Block Mopar Top Fuel, Top Alcohol, Blower Drive

Standard Features

- Machined from EN30B alloy steel
- Rod journal diameters: 2.375" with large .180" fillet radii
- Main journal diameters: 2.750" or 3.000" with large .150" fillet radii
- RCD Splined post: long 2.340" or short 1.420" spline engagement available
- Sold complete with no drill balance included
- Aeroshed super finishing is standard
- Fully counterweighted with large, bearing saver counterweights
- All rod and main journals drilled for lightening
- PSI / RCD Spline Post Hemi Forged Billet also available

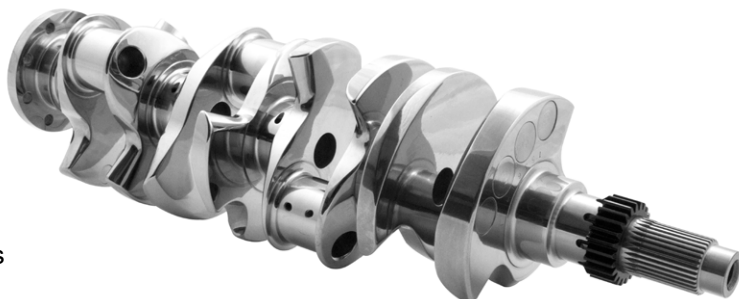

Mopar Magnum Billet

Average weight for a 4.500" stroke balanced to 2350g Bob. = 69 lbs.

Available Options & Standard Features

- Center counterweights
- 4330 Steel
- Gun drilled mains
- All Rod Journals Lightened
- Dual Post Keyways
- Stroke availability 4.125" to 5.000"
- 2.200 BB Chevy rod journal dia. & width



Mopar Magnum Billet

Stroke:	Main:	Pin:	Cammed for Rod Length	Part #
4.150	2.750	2.200	6.700	GE262@-MB
4.250	2.750	2.200	6.700	GEP62@-MB
4.500	2.750	2.200	7.100	GEQ62@-MB

Stroke:	Main:	Pin:	Cammed for Rod Length	Part #
4.625	2.750	2.200	7.100	GER62@-MB
4.750	2.750	2.200	7.100	GES62@-MB
5.000	2.750	2.200	7.100	GEV62@-MB

Mopar Magnum

Average weight for a 4.500" stroke balanced to 2350g Bob. = 64 lbs.

Available Options & Standard Features

- Gun drilled mains
- All Rod Journals Lightened
- Dual Post Keyways
- Stroke availability 3.750" to 5.000"
- Heat Treatment = Ultra Case Deep Nitride
- Custom Flange Bolt & Dowel Drilling
- 2.200 BB Chevy dia. & width, 2.375 Mopar rod journal dia. & width



Mopar Magnum

Stroke:	Main:	Pin:	Cammed for Rod Length	Part #
4.150	2.750	2.200	6.700	GE262J-MP
4.250	2.750	2.200	6.700	GEP62J-MP
4.500	2.750	2.200	7.100	GEQ62J-MP

Stroke:	Main:	Pin:	Cammed for Rod Length	Part #
4.625	2.750	2.200	7.100	GER62J-MP
4.750	2.750	2.200	7.100	GES62J-MP
5.000	2.750	2.200	7.100	GEV62J-MP

Gen III Ultra UB Hemi

Average weight = 60 lbs.

Standard Features

- Fully (8) Counterweighted design
- Machined from 4330 TimkenSteel
- Uniquely machined counterweight profile for reduced weight and windage
- Gun drilled mains
- All rod journals lightened
- Heat Treatment = Ultra Case Deep Nitride
- Full support pin top for added strength
- Available Upon Request: Full internal balance to your specific assembly weight - No Drilling



Gen III Hemi - 8 Counterweight Magnum

Stroke:	Main:	Pin:	Cammed for Rod Length	Part #
3.800	2.559	2.100	6.125	YYK-E1V-MG
4.000	2.559	2.100	6.125	YYO-E1V-MG
4.050	2.559	2.100	6.125	YY*-E1V-MG

Gen III Hemi - 8 Counterweight Magnum

Average weight = 52 lbs.

Standard Features

- Stroke range of 2.800" to 4.600"
- Fully counterweight prepped for a minimum 1850g. bob weight
- Dual linear post keyways
- Average weight 47-55 lbs
- Gun drilled mains & lightened rods
- 2.100", 2.000", 1.888", 1.850" rod journal diameters



Compstar Gen III Modern Hemi

Stroke:	Main:	Pin:	Cammed for Rod Length	Part #
3.800	2.559	2.100	6.125	YYKE18-CS
4.200	2.559	2.100	6.125	YY12E48-CS

Compstar Gen III Modern Hemi

Average weight for 4.050" stroke balanced to 1785g

Bob. = 57 lbs.

Standard Features

- Sold prepped for a 1785g. Bob weight
- Gun drilled mains
- All rod journals lightened
- Dual linear post keyways

Compstar 8 Counterweight Hemi

Stroke:	Main:	Pin:	Cammed for Rod Length	Part #
3.800	2.559	2.100	6.125	YYK-E1Q-CS
4.000	2.559	2.100	6.125	YYO-E1Q-CS
4.050	2.559	2.100	6.125	YY*-E1Q-CS
4.080	2.559	2.100	6.125	YYA-E1Q-CS

Compstar Big Block Mopar

Standard Features

- 6 Counterweight design
- Manufactured from 4340 steel

Compstar Big Block Mopar

Stroke:	Main:	Pin:	Cammed for Rod Length	Part #
3.760	2.750	2.200	6.535	GE3-65L-CS
4.150	2.750	2.200	6.535	GE2-62L-CS
4.250	2.750	2.200	6.535	GEP-62L-CS
4.500	2.750	2.200	6.700	GEQ-62L-CS
4.625	2.750	2.200	6.700	GER-62L-CS

- All rod journals lightened
- Heat Treatment = Nitride Case
- Counterweight prepped to a 2400 Bob Weight





Compstar Jeep 4.2 Liter Inline 6 Cast Iron

Stroke:	Main:	Pin:	Part #
3.895	2.500	2.096	S28000

Connecting Rods

Mopar Ultra Enforcer I-Beam - Rated for 2,000 HP

Length	Journal	Typ. Wt.	Part #
6.200	2.123	764g.	U14345

Mopar Gen III Hemi Drag Pack Ultra H-Beam

Length	Journal	Typ. Wt.	Part #
6.300	2.100	658g.	U16130

Compstar Xtreme - SBC Style : Use with Gen III Hemi Rated for 1,800 HP

Length	Journal	Typ. Wt.	Part #
6.000	2.100	645g.	CSA6000DS2A2AX
6.125	2.100	653g.	CSA6125DS2A2AX

Gen III Hemi Compstar H-Beam - Rated for 1,000 HP

Length	Journal	Typ. Wt.	Part #
6.125	2.100	617g.	CSA6125DS2A2AH
6.150	2.125		CSD6150GS2E1AH
6.250	2.125		CSD6250GS2E1AH

Big Block Mopar Ultra I-Beam

Length	Journal	Typ. Wt.	Part #
7.100	2.200	848g.	U15270
7.100	2.200	848g.	U15270-CA *CA Bolts

Compstar Xtreme - BBC Style : Use with Big Block Mopar Rated for 1,800 HP

Length	Journal	Typ. Wt.	Part #
6.700	2.200		CSB6700ES3BDAX

Big Block Mopar Compstar H-Beam - Rated for 1,000 HP

Length	Journal	Typ. Wt.	Part #
6.760	2.375		CSE6760FS3D5AH
6.700	2.200	825g.	CSB6700ES3B9AH
6.800	2.200	842g.	CSB6800ES3B9AH
7.100	2.200		CSB7100ES3B9AH



Head Studs for Gen III Hemi - Cast Iron Block

Part #:	Material:	
CPP10625	Patriot Grade	20 M12 & 10 M8
CPP10626	TorqueMaster	20 M12 & 10 M8

Main Studs for Gen III Hemi - Cast Iron Block

Part #:	Material:
10414	Patriot Grade
10414-TM	TorqueMaster



OptiTorque	Material Grade	OptiTorque Tensile Strength
Patriot	8740 Chrome Moly	180-220 ksi
TorqueMaster	HSLA 6304	190-240 ksi



Gen III Main Caps

- Billet 4140 Material
- Fits OEM Cast Iron Blocks
- ID sized for proper boring and honing

Gen III Main Caps

Part #:

000-G3HKIT	Main Caps
000-G3HMSTK	Main Caps / Main Stud Combo
000-G3HMHSTK	Main Caps / Main & Head Stud Combo



M16 Damper Bolt

Part #:

06512335AA



Gen III Hemi VVT Post Spacer

Part #:

CPP-0550

Used in all VVT applications

Gen II Hemi / Wedge Cast Iron Block Components

Part #:

832486-5-A-M	Main Bearing Cap #1,2,4
832486-5-B-M	Main Bearing Cap # 3
832486-5-C-M	Main Bearing Cap #5
000-1256	Rear Oil Seal Retainer
HAR3.500-5	Hex Bolt, 1/2-13 x 3.500
HAR4.000-5	Hex Bolt, 1/2-13 x 4.000
H3AJ2.750-5CL	Hex Bolt, 3/8-16 x 2.750
ARW78	Chamfered Washer 1/2 ID x 7/8
RJW750	Chamfered Washer 3/8 ID x 3/4
P5007167-7	Hollow Dowel 0.700x0.625
000-1257	Hollow Dowel Rev. IR 4340 CFA
91271A638	3/18" - 16 Thread Size, 3 1/2" Long Bolt

Part #:

91375A617
P1737725
555-030-B
22S-S12
555-065-B
44605K232
44605K233
27931
91251A539
PD-17
1122532

Oil Gallery 3/8"-16 Plug 0.040"
Distributor Bushing - Bronze
Press in Freeze Plugs 1.625"
12 AN Plug - Aux Pick Up
Press In Rear Cam Plug 2.1406
1/4"-18 NPTF Pipe Plug
3/8"-18 NPTF Pipe Plug
1/2" Oil Pick Up Tube Adapter
1/4"-20x5/8" A574 Socket Head
Durabond Camshaft Bearing Kit
Dowel - Bell Housing 1/2"x3/4"



Reluctors

Part #:

05037457A	32 Tooth Chrysler 6.4 OEM Reluctor
05037457AA	32 Tooth Chrysler 6.4 Billet Reluctor
04893290AA	58 Tooth Chrysler 6.4 OEM Reluctor
04893290AAB	58 Tooth Chrysler 6.4 Billet Reluctor

Reluctor Bolts

Part #:

0658103AA	Hemi reluctor bolts
-----------	---------------------



32 Tooth 6.4 OEM Reluctor



58 Tooth 6.4 Billet Reluctor

Callies Finish Ground Cams

Callies fully finished camshafts are machined and heat treated entirely in house. This continuity of manufacturing allows Callies to deliver high quality camshafts on schedule. Our finished cams are ground with the latest Landis CNC technology. They are ADCOLE and Jenoptik inspected for accuracy, making them the most consistent cams on the market today. If required, your cams can be finished with inverted flank lobe profiles and complex VVT oil channels and drillings.



Valve Train Group - VTG is the finish ground series of camshafts manufactured by Callies Performance Products. We offer cams to serve a wide variety of applications for many popular engine platforms.

VTG cams are available in multiple types of aircraft quality materials. Less aggressive profiles fit nicely within our induction hardened 1050 or 4150 materials. 8620 carburized material works well for many racing applications. Tool steel is available for the most extreme applications.

Callies Finish Ground Cam List - VVT Gen 3 Hemi

Callies Part #	Solid or Hyd	Duration @ .050		Advertised Duration (@ .006)		Cam Lift		Valve Lift w/1.6 Rocker		LSA + Advance	Lobe Ctr.		Lift @ TDC		Application
141 - VVT Hemi		Intake	Exhaust	Intake	Exhaust	Intake	Exhaust	Intake	Exhaust		Intake	Exhaust	Intake	Exhaust	VVT Gen 3 Hemi
141-001	HR	232	242	282	292	0.385	0.385	0.616	0.616	116 + 10	106	126	0.084	0.037	Low speed grunt
141-002	HR	236	246	286	296	0.385	0.385	0.616	0.616	118 + 10	108	128	0.084	0.037	Great balance of performance
141-003	HR	240	250	290	300	0.385	0.385	0.616	0.616	120 + 10	110	130	0.084	0.037	More high speed street power
141-004	HR	242	252	292	302	0.390	0.390	0.624	0.624	119 + 10	109	129	0.091	0.042	Street / strip performance
141-005	HR	246	256	296	306	0.390	0.390	0.624	0.624	121 + 10	111	131	0.091	0.042	Big street / strip w/ big displacement engine
141-006	HR	256	260	300	310	0.390	0.390	0.624	0.624	123 + 10	113	133	0.091	0.042	Geared towards racing

MOPAR / HEMI



Without steady and reliable access to a **Gen II Cast Iron Hemi** in over a decade car enthusiasts and sportsman racer's have been left to scour scrapyards, market places, and garages to create a workable and affordable solution. Our new licensing deal with FCA group will allow you to tap into this legendary platform on demand at an affordable price.

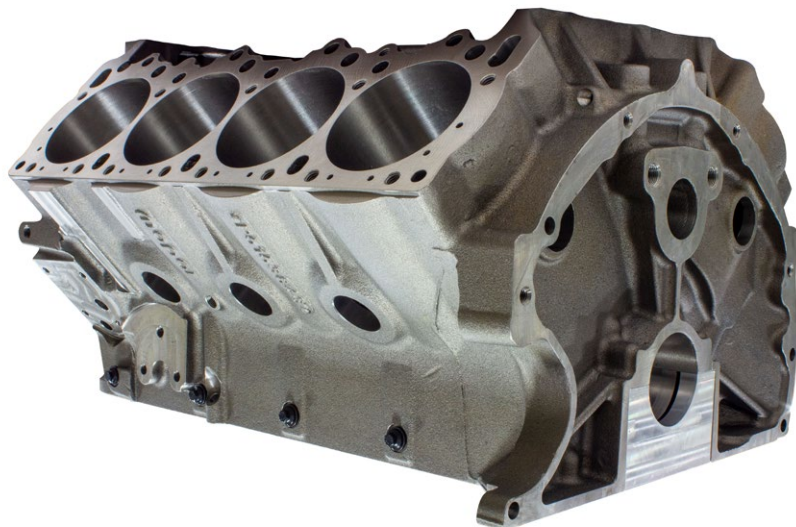

**OFFICIAL
LICENSED
PRODUCT**

HEMI®

Gen II Cast Iron Hemi / Wedge

Standard Features

- Configurations Available for Order:

Description	Part #
Hemi with 4.495" Semi Finish Bore	P5160208AA
Hemi with 4.245" Semi Finish Bore	P5160210AA
Hemi with 4.245" Semi Finish Bore	P5160211AA
- No lifter bores or pushrod clearance	
Wedge with 4.495" Semi Finish Bore	P5160213AA
Wedge with 4.313" Semi Finish Bore	P5160212AA

ENERGY
MANUFACTURING

- Deck Height(s): Standard Deck: 10.725", Deck Thickness: .600"
- Camshaft: Cam Height: Standard 5.150"
- Camshaft: Housing Bore: Delivered with Standard Stepped Cam Tunnel at finish size. Max Cam Housing Bore Size: 60mm Roller Bearing.
- Cylinder Bore: Max Cylinder Bore Diameter: 4.600"
- Lifter: Lifter Diameter: .905", Lifter Angle: 45 degrees
- Main Cap Fastening: #1-4 Main Cap: (2) 1/2" Vertical Bolts, (2) 3/8" Side Bolts, #5 Main Cap: (2) 1/2" Vertical Bolts
- Delivered with Finish Honed Crankshaft Housing Bore

Included with Block: Block Plug Kit, Camshaft Bearings (Loose), 0.040" Oil Gallery Restrictors (Installed), Rear Oil Seal with Fasteners.

All block part numbers can have cylinder bores finish honed upon request for an additional charge.

Orders for the Gen II Cast Iron Hemi / Wedge Block can be placed by calling Callies Performance Products

MOPAR and related logos, vehicle model names and trade dress are trademarks of FCA US LLC and used under license. ©2024 FCA US LLC

Callies Performance Products www.callies.com **419-435-2711**



**OFFICIAL
LICENSED
PRODUCT**

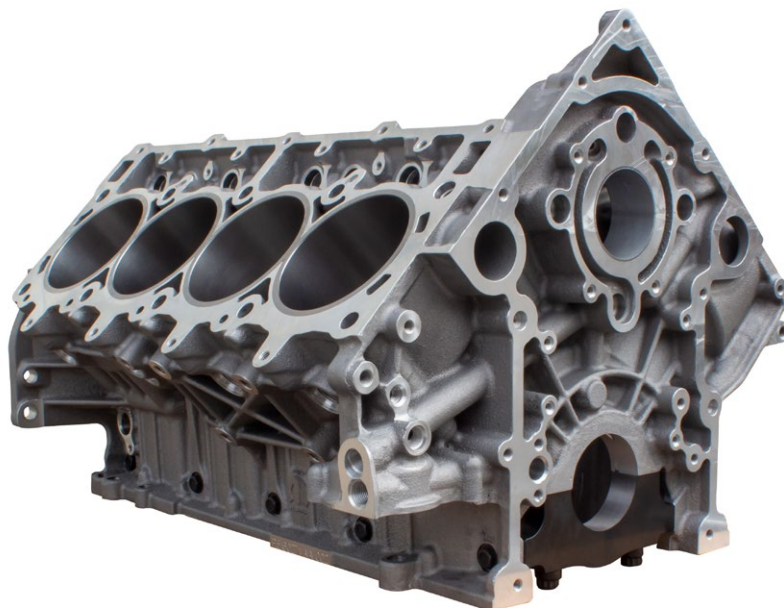
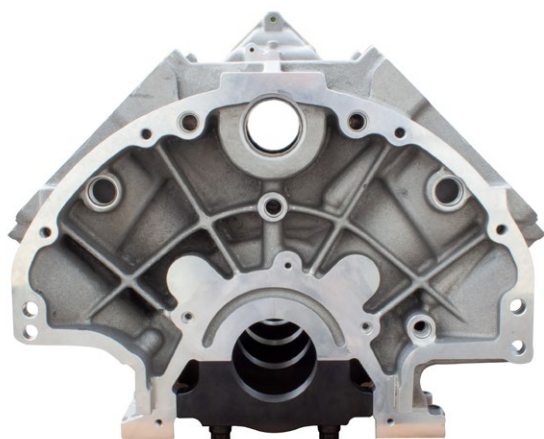

Gen III Cast Aluminum Engine Block

Standard Features

Hellephant Block: P5160271AA

- 9.25" Deck Height
- 6.2/6.4 Timing Drive, VCT Solenoid
- Standard Lifter Pattern, .842 lifter bores
- Standard cam bore, bearings installed
- Delivered w/ 4.120" bores, require finish honing to 4.125"
- 4140 q/t billet main caps
- 4 bolt M1 & M5, 6 bolt M2-M4
- M12 Head Studs Available

ENERGY
MANUFACTURING

Dragpak Block: P5160272AA

- 9.25" Deck Height(stock is 9.284")
- 6.1 Timing Drive, No VCT Solenoid
- .937 Keyway lifter bushings, require finish hone
- 60mmRB cam bore, bearings not included
- Delivered w/ 4.120" bores, require finish honing to 4.125"
- 4140 q/t billet main caps
- 4 bolt M1 & M5, 6 bolt M2-M4
- ½" Head Studs Available

Orders for MOPAR Blocks can be placed by calling Callies Performance Products at 419-435-2711

MOPAR and related logos, vehicle model names and trade dress are trademarks of FCA US LLC and used under license. ©2024 FCA US LLC

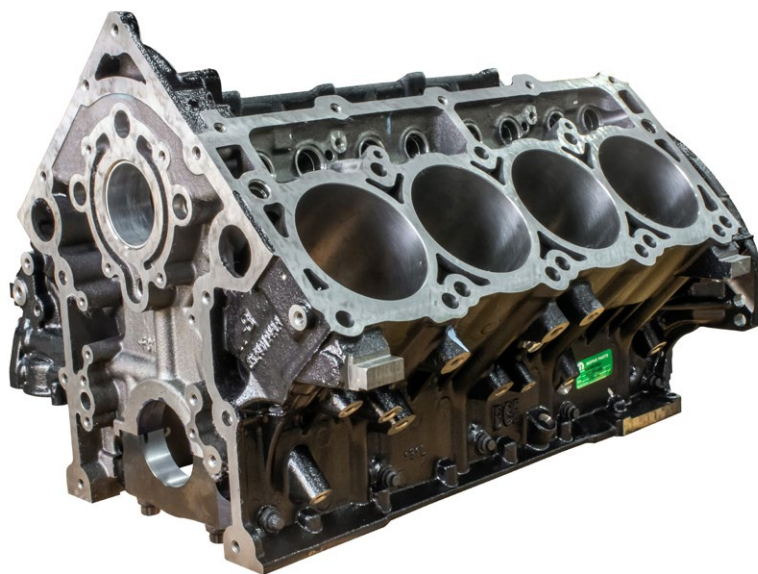
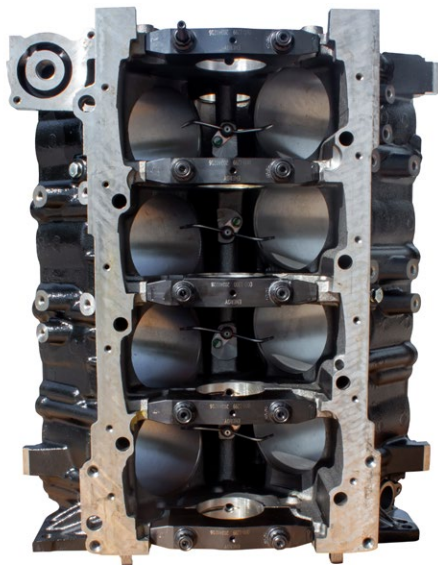

Gen III Hemi 6.4L Cast Iron "BGE" Bare Block

Description	Part #
6.4L Block only	05045475AG
- With OptiTorque main stud kit	05045475AG-MS KIT
- With main studs and Energy main billet caps	05045475AG-KIT
- With studs, caps, and line honing installed	05045475AG-ASSY

 **6264**

Hellcat 6.2L Bare Engine Block

Description	Part #
6.2L Block only	68166434AD
- With OptiTorque main stud kit	68166434AD-MS KIT
- With main studs and Energy main billet caps	68166434AD-KIT
- With studs, caps, and line honing installed	68166434AD-ASSY



**OFFICIAL
LICENSED
PRODUCT**

Gen III Hemi Cylinder Heads & Rockers

Description	Part #
Cylinder Head Right Hand for 18-23 Demon, Challenger, Charger SRT Hellcat, Redeye, Jailbreak	53010852AE
Cylinder Head Left Hand for 18-23 Demon, Challenger, Charger SRT Hellcat, Redeye, Jailbreak & Super Stock	53010853AE
Rocker Arm Assembly Intake for 5.7/6.1/6.2/6.4L	53021552AB
Rocker Arm Assembly Exhaust for 5.7/6.1/6.2/6.4L	53021553AB
Engine Cylinder Head Assy, Left Hand, Head, 6.4L Heavy Duty V8 Hemi with MDS, 2014-2024 Ram	68280509AE
Engine Cylinder Head Assy, Right Hand, Head, 6.4L Heavy Duty V8 Hemi with MDS, 2014-2024 Ram	68280508AE
Cylinder Head Right Hand for 11-23 6.4L	68280510AD
Cylinder Head Left Hand for 11-23 6.4L	68280511AD

Orders for MOPAR Blocks can be placed by calling Callies Performance Products at 419-435-2711

MOPAR and related logos, vehicle model names and trade dress are trademarks of FCA US LLC and used under license. ©2024 FCA US LLC